



## SPECIFICATION SHEET

**Product Code**

102-9107

**Product Description**
**Rewireable C13 IEC Lock+ LSZH  
Appliance Outlet (Black)**

- Rewireable
- Fits any standard C14 outlet
- Anti-Vibrate
- Integral plug retention feature
- Easy pull handle
- Slotted and Cross head housing screws
- Appliance inlet suitable for cold conditions

**General Information**

<b>Rated Current / Voltage</b>	10A/250V~
<b>Number Of Poles</b>	2 + Earth (2 + PE)
<b>Materials</b>	Outer Body: Nylon (PA66) LSZH (RAL 9004 Signal Black)
	Housing Lid: Nylon (PA66) LSZH (RAL 9004 Signal Black)
	Chassis & Chassis Lid: Nylon (PA66) LSZH (RAL 9004 Signal Black)
	Cable Restraint: Nylon (PA66)
	Housing Screws & Cable Restraint Screws: Steel
	Lock Pivot Lever: Polycarbonate
	Terminal Block & Sliding Terminal: Brass
	Terminal Screws: Steel Brass Coated
	Spring: Spring Steel
	Locking Blade: Hardened Steel Zinc Plated
	Red Handle: Polycarbonate LSZH (RAL 3020 Traffic Light Red)
<b>Terminal Capacity</b>	3 Core 1.5mm <sup>2</sup> Maximum / 14-18 AWG, 2.5mmø Terminal Diameter
<b>Torque Value</b>	Terminal Screws; 0.4Nm, Strain Relief Clamping Screws; 0.3Nm
<b>Operational Temperature</b>	-20°C To +55°C
<b>Dielectric Strength</b>	1.5 kV Max
<b>Withdrawal Force</b>	>100N
<b>Flammability Rating</b>	Equivalent to UL94V-0
<b>Protection Class</b>	Suitable for appliances with protection Class I according to IEC EN 61140
<b>Wire Stripping Lengths</b>	Live & Neutral: 18mm
	Earth: 23mm

**Standards & Approvals**

KEMA-KEUR Certified: 2186208.01 - EN 60320-1:2001+A1:2007

UL File: E475619 - UL 60320-1 / CSA C22.2 No. 60320-1

SAA Certified: SAA-151920-EA - AS/NZS 60320.1.2012

**DIREKTRONIK**

Dataprodukter utöver det vanliga



## SPECIFICATION SHEET

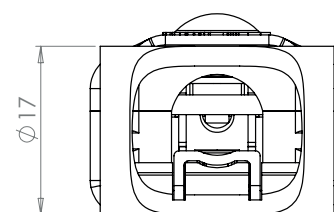
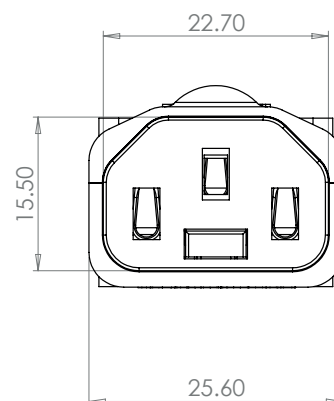
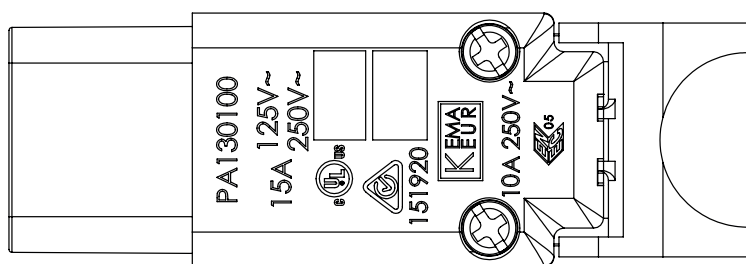
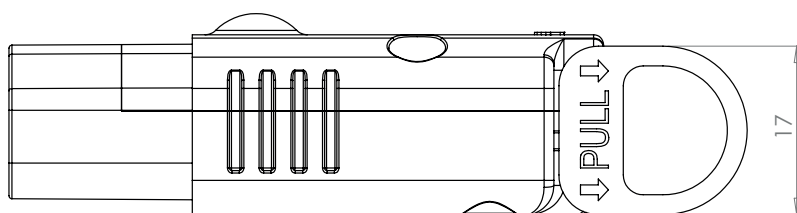
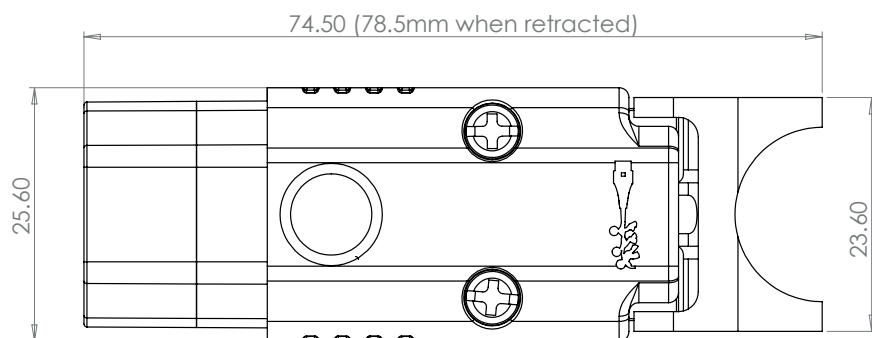

to change without notice

# DIREKTRONIK

Dataprodukter utöver det vanliga