



Outdoor 4 Port Fiber PoE Switch

Product Overview

4-port PoE switch with water-proof metal casing. It has sealing gasket inside which passed extension, bearing, corrosion, aging test. 4 ports include 1 SFP port and 3 PoE output ports with 6KV (10/ 700us) surge protection, each PoE output port provides 55Vdc, 0.55A power for remote PDs. It supports 10/100/1000Mbps of data speed.

It is compliant with IEEE802.3at standard and is also compatible to use with any IEEE802.3af standard equipments, such as wireless APs, network camera, VoIP phone, base stations, and other high power Ethernet terminals.

Designed for outdoor using. It works with input voltage of 100-240Vac and operates under -40°C to +65°C. It has detection chip inside, which will detect and classify PD before powering it. It will not provide power until a standard-compliant PD is detected. The effective distance is 100 meters over Cat5e/Cat6 cables.

It is specially suitable for working in complex power situations. It is easy to install with installation kit no need to open the equipment.



Product Profile

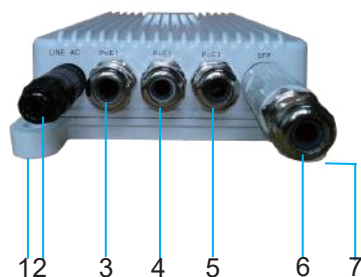

- 2. LINE AC: AC Power Input Port
- 3. PoE 1: Data&Power Output Port
- 4. PoE 2: Data&Power Output Port
- 5. PoE 3: Data&Power Output Port

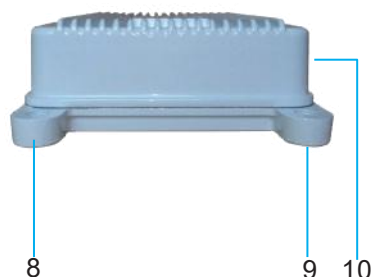

- 6. SFP: Data Input Port
- 1,7,8,9. Mounting Hole
- 10. Earth

Product Working Diagram

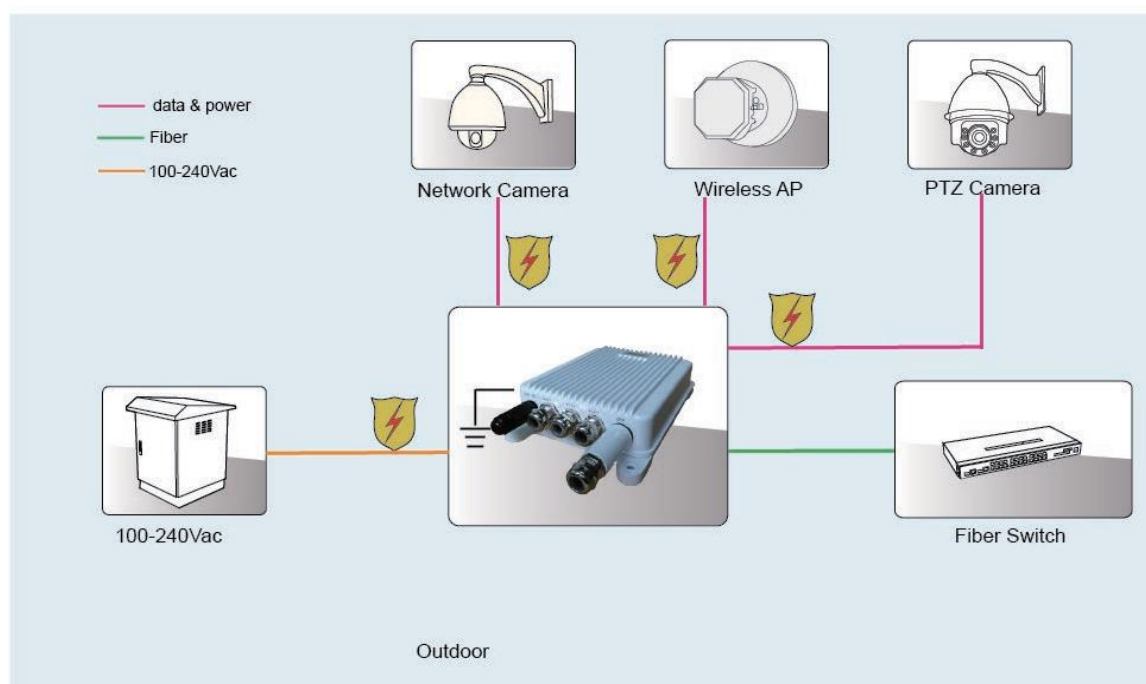

Specification

Standard

- IEEE802.3 10Base-T Ethernet
- IEEE802.3u 100Base-Tx Fast Ethernet
- IEEE802.3ab 1000Base-T Gigabit Ethernet
- Compliant with IEEE802.3af/at
- RoHS Compliance
- WEEE Compliance
- Protection Level: IP67, IEC60529

Input & Output

- Input :100-240Vac 2A 50Hz ~ 60Hz
- Output: 55Vdc 550mA (Per Port) * 3 Ports, total 90W
- Power Output Pins: 3/6(+), 1/2(-)
- Data Speed: 10/100/1000BASE-T RJ45 Interfaces
1000BASE-X SFP Interfaces

Working Environment

- Operating Temperature: -40°C to 65°C
- Operating Humidity: 20% to 90%, non-condensation
- Storage Temperature: -40°C to 85°C
- Storage Humidity: 10% to 95%, non-condensation
- Operating Altitude: up to 5000meters

AC Surge Protection

- Line-Earth 1.2/50us (8/20us): 6KV
- Line-Line 1.2/50us (8/20us): 4KV

PoE Surge Protection

- Protected line: 1,2,3,4,5,6,7,8
- Common mode surge protection(10/700us): 6KV
- Differential mode surge protection (10/700us): 1.5KV

Mechanical Characteristics

- Case: Aluminum Alloy
- Color: White
- Mounting: Wall-mounted/Pole-mounted
- IP Rated: IP67
- Size: 176mm X 269mm X 65mm
- Weight: 1.8kg

Safety Approvals

- CE

EMI

- FCC CFR47 Part 15, EN55032, EN55035

EMS

- IEC61000-4-2(ESD) ± 4 kV(contact), ± 8 kV(air)
- IEC61000-4-3(RS) 3V/m(80MHz~1000MHz)
- IEC61000-4-4(EFT) Power Port: ± 1 kV; Data Port: ± 0.5 kV
- IEC61000-4-5(Surge) Line to Line: ± 1 kV, Line to Earth: ± 2 kV
- IEC61000-4-6(CS) 3V(0.15MHz~10MHz)

Immunity

- IEC60068-2-6(Vibration)
- IEC60068-2-27(Impact)
- IEC60068-2-32(Free Fall)

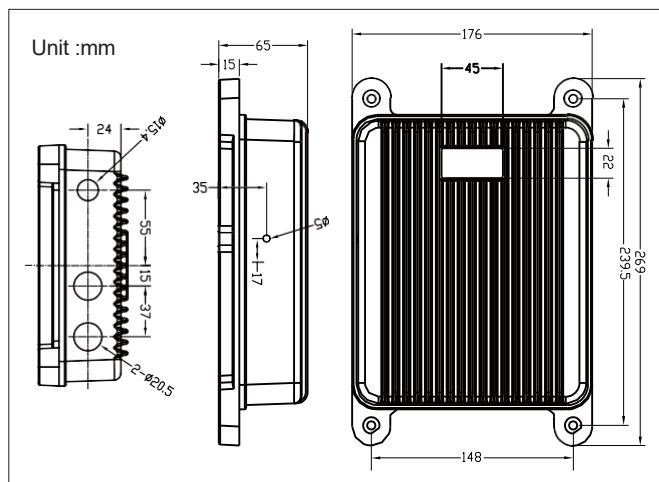

DIREKTRONIK